

LANDSCAPE NOTES

- SHRUB/GROUND COVER PLANTING SHALL BE DROUGHT TOLERANT DESERT PLANTS.
- ALL SHRUBS AND TREES SHALL BE IRRIGATED USING DRIP SYSTEMS.
- FINAL PLANTING AND IRRIGATION PLANS SHALL BE SUBMITTED FOR APPROVAL.
- TREE MATERIAL (24" BOX)
BOTANICAL NAME COMMON
NAME

- | | |
|---------------------|-----------------|
| CERCIDIUM HYBRID | DESERT MUSEUM |
| WASH FILIFERA | CALIFORNIA PALM |
| BRACHY POPOLNUM | BOTTLE TREE |
| ALBIZZA JULIBRISSIN | MIMOSA |

- | | |
|--|---------------|
| LYCIANTHES RANTONNATI | PURPLE POTATO |
| GROUND COVER BARK OR GAZANIA SPLENDENS COVER | MIXED COLORS. |

PROPOSED AREA TO BE LANDSCAPED SCHEMATIC ONLY
FINAL PLANS TO BE SUBMITTED

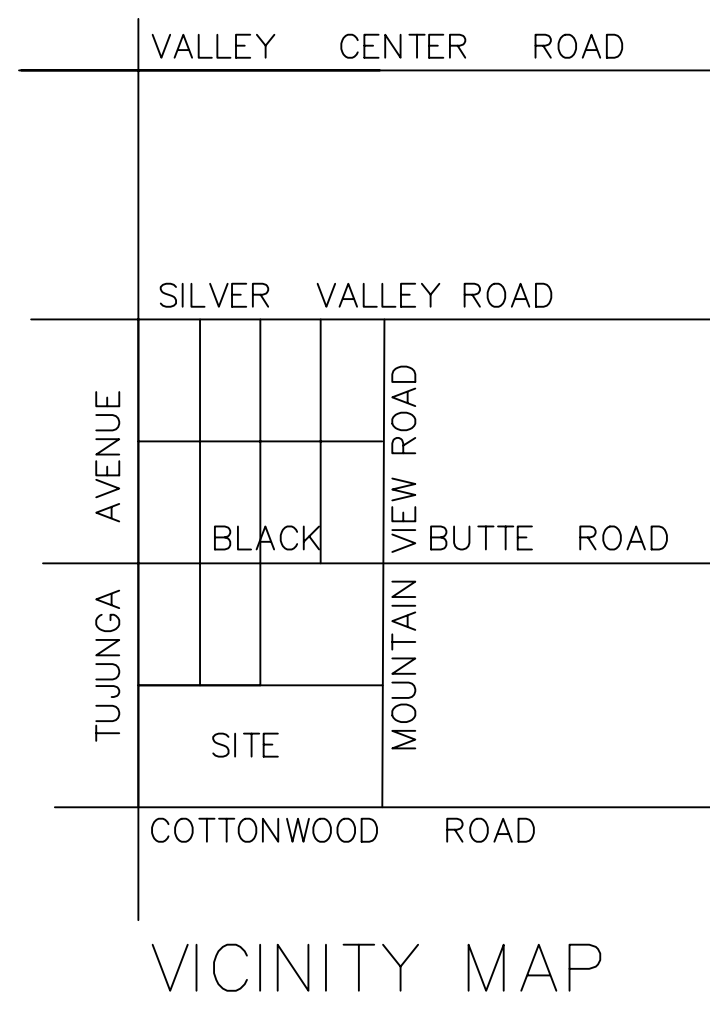
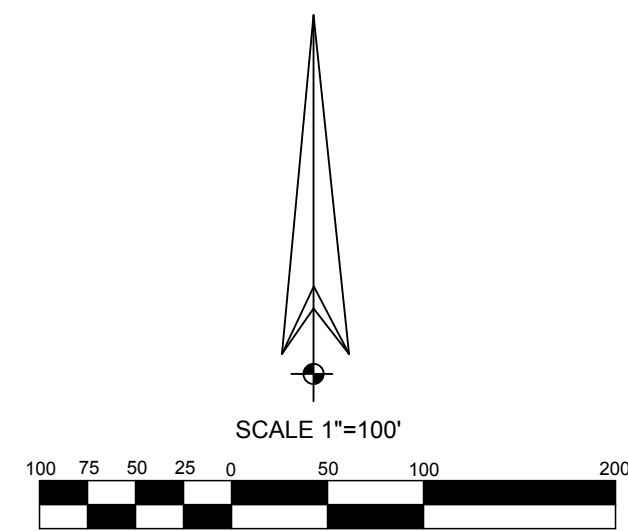
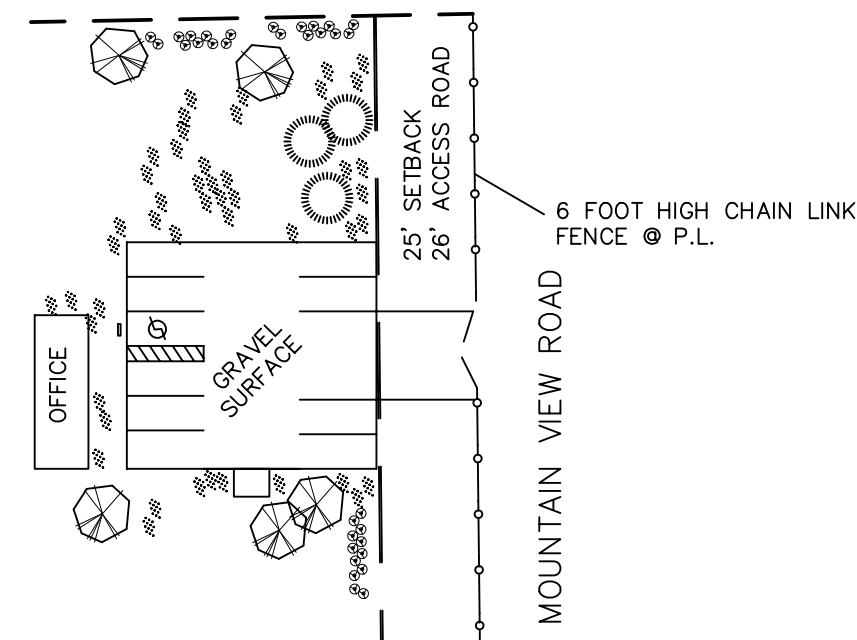

FOR OFFICIAL USE ONLY

LEGEND

- (A) COMMERCIAL MOBILE OFFICE- SELF CONTAINED - SERVICED BY PUMPING COMPANY AS REQUIRED.
- (B) TRASH ENCLOSURE - CONCRETE BLOCK 7'x5' w/SOLID GATE.
- (C) EXISTING WELL TO SERVICE OFFICE.
- (D) WATER STORAGE TANK - RMI-G 2,600 GAL. ROTONICS MANUFACTURING, INC. (OR EQUAL)
- (E) GATES - SECURED WITH "KNOX" PADLOCK MODEL #3772.
- (F) INSTALL 6" FIRE HYDRANT w/TWO-2 1/2" AND ONE 4" OUTLET

LEGAL DESCRIPTION

SOUTH 1/2 OF SOUTHEAST 1/4 OF SECTION 20, TOWNSHIP 9 NORTH, RANGE 3 EAST, SAN BERNARDINO BASE AND MERIDIAN PER GOVERNMENT SURVEY.

AREA
80 ACRES TOTAL
AREA "A-EAST" = 2.78 ACRES
AREA "A-WEST" = 10.44 ACRES
AREA "B" = 13.64 ACRES

UTILITIES

ELECTRIC:
SOUTHERN CALIFORNIA EDISON
30553 RIM ROCK ROAD
BARSTOW, CA
92311
1-800-990-7788

TELEPHONE:
VERIZON COMMUNICATIONS
TELEPHONE AND CABLE
1-800-483-1000

WATER
EXISTING PERMITTED WELL

GAS:
NONE

- GENERAL NOTES:
- NO GRADING PROPOSED. CLEAR AND GRUB ONLY PER EXISTING PERMIT # 02-10-1379.
 - SITE CONTAINS "NO PROTECTED PLANTS".
 - SOLAR PANELS ARE 77.0" LONG, 39.1" WIDE 2.0" DEEP. 6" MAX ABOVE GROUND.
 - 50' TURNING RADIUS (FIRE DEPT.)

CUP FOR TWO SOLAR FARMS (LOTS A AND B)

APN #0531-231-55-0000
ADDRESS
32952A AND B
MOUNTAIN VIEW ROAD
NEWBERRY SPRINGS, CA
92365

APPLICANT:
SOLUTIONS FOR UTILITIES, INC.
1192 SUNSET DRIVE
VISTA, CA
92081
PHONE: 760-724-4420
FAX: 760-724-8095
ATTN: MARY HOFFMAN

PROPERTY OWNER:
HOFFMAN FAMILY LIVING TRUST DATED JUNE 9, 2005.
1192 SUNSET DRIVE
VISTA, CA
92081
PHONE: 760-724-8550
FAX: 760-724-8095

PLAN PREPARER:
LAWRENCE O. McDERMOTT
18075 LAVENTANA
MURRIETA, CA
92562
PHONE: 951-304-0111
FAX: 951-696-5218
EMAIL: larry0007@verizon.net

PLOT PLAN PREPARATION DATE - MAY 26, 2009
REVISION DATE:

Prepared By:
Lawrence O. McDermott
RCE/PLS
18075 LaVentana
Murrieta, Ca. 92562
951-304-0111
e-mail - larry0007@verizon.net



Lawrence O. McDermott RCE 23107 Date

NO.	DATE	BY	DESCRIPTION	APPROVED
3	3/22/2010	LMD	Cottonwood 44' dedication, & moved PH to storage tank	
2	3/10/2010	LMD	GENERAL REVISIONS	
1	6/14/2009	LMD	GENERAL REVISIONS	